

# Assembly Instructions for: R9193 and R9195 Dress Up



**Warning: Choking Hazard**  
Assembly hardware contains small parts. **Adult assembly required.**



**Warning: No Climbing** Units are not intended for children to climb on and it is recommended that units **over 32 inches tall** be **attached to a wall to prevent tipping.**

**Required Tools:**  
Medium Size  
Phillips Screwdriver

Instructions: Unbox unit and find hardware bag inside of box.

To assemble R9193 or R9195 follow these instructions:

- 1 - Take the Top and Bottom Side pieces (if not already attached to their bottom boards) and attach by putting a the board into the sides grooves and screwing together with screws provided.  
( See exploded view #1)  
At this point attach the coat hooks provided to the bottom of the top shelf assembly.
- 2 - Take assembled bottom and top pieces and place one at a time into the grooves on the end pieces.
- 3 - Once one end is attached to both top and bottom shelves, carefully turn over and repeat the process for the other end piece.

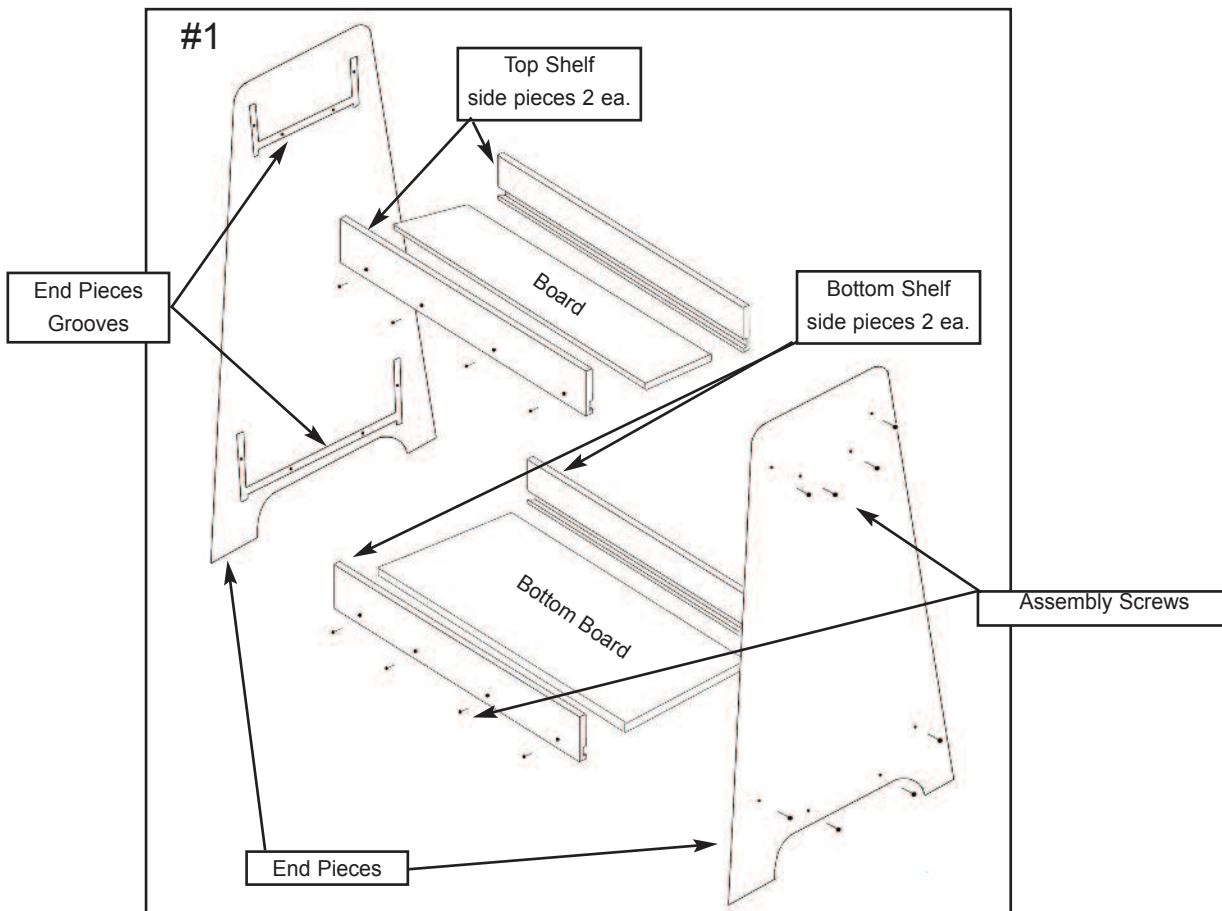

If you have any difficulties assembling this product, please call Childs Play Customer relations at (800) 447-8375 or email us at [mail@childsplay1.com](mailto:mail@childsplay1.com)  
Childs Play 131 Yorktown, Dallas, Tx. 75208  
[www.childsplay1.com](http://www.childsplay1.com)